

# SUNMI 80MM Label Printer <sup>New</sup>

A New Breed of Printer for Smarter Business.

Compatible with  
**SUNMI DMP**



## Seamless Scan&Print Solution

Enhance efficiency with an optional barcode scanning module. Our Professional camera supports product entry, QR code payments, and scan for outbound delivery, all in one device.

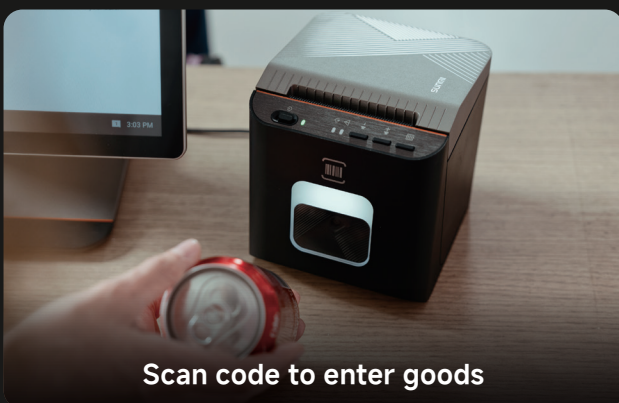

## 3-in-1 Printer

Seamlessly integrates three printing modes—Receipt paper, Label paper, and Linerless label—into one device.



## Revolutionary one-cable power supply

Industry-first Single-cable power supply patent enables simultaneous power delivery and data communication through a single cable for a clean, tidy countertop.

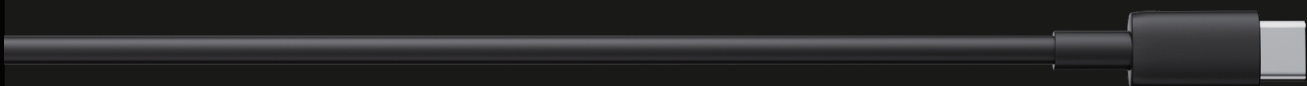

## Innovative Dual Stacking Design \*

Doubles operational efficiency while fully freeing up front-desk workspace.



\*The Dual Stacking device stand must be purchased separately.

## Supports multi-channel transaction printing

Supports Bluetooth / LAN / Wi-Fi / USB / Hyper Wi-Fi\*  
Once connected, it's ready to print instantly upon power-on.

**HYPER  
Wi-Fi**

Hyper Wi-Fi



蓝牙



LAN



Wi-Fi



USB

\*Hyper Wi-Fi functionality requires customization.

## Supports Cloud printing

Integrate via Open API to enable remote printing—enjoy hassle-free cloud printing, no more missed orders.



## SUNMI 80MM Label Printer Specs

### Product Model

NT320

### Printer

Print Method: Line Thermal  
Print Resolution: 203\*203dpi  
Print Speed: Up to 150mm/s

### CPU

MIPS32 1.2GHz

### Ports

1\*RJ12 Cash Port  
1\*RJ45 LAN  
1\*USB2.0 Type-C

### Ethernet

100Mbps

### Memory

RAM: 128MB  
ROM: 256MB

### Audio

1\*1W Speaker

### Sensor

Out of Paper Sensor, Gap Sensor, Open Cover Sensor, Paper Pick-Up Sensor, Cutter Reset, Motor temperature sensor, Head temperature sensor

### Characters Per Line

Width 80mm: Font A: 48, Font B: 64  
Width 58mm: Font A: 33, Font B: 44  
Width 40mm: Font A: 21, Font B: 28

### Font Type

Simplified Chinese (GB18030), Traditional Chinese (BIG5), Japanese (Shift JIS), Korean (KS C 5601), English, Emoji, Global Fonts Library

### Paper Size

Paper Width: 30mm-80mm  
Max diameter: 80mm  
Label Width: 30mm-78mm  
Label Height: 30mm-150mm  
Thickness: 0.048mm-0.10mm

### Print Command

Receipt: ESC/POS  
Label: TSPL  
Cloud Communication: MQTT/HTTPS

### Power Supply

5V/2A DC

### Certification

CCC, IC, CE, CB, FCC, WEEE, Rohs, Reach, SRRC

### Supported Operating System

Windows/Android/iOS/Linux/SUNMI MDM

### Dimensions (L\*W\*H)

130\*140\*145 mm

### Weight

875g

### Environment

Operating Temperature: 0°C~45°C  
Operating Humidity: 30%-85% non-condensing  
Storage Temperature: -20°C~45°C  
Storage Humidity: 10%-90% non-condensing

### Bar Code

1D: UPC-A, UPC-E, JAN13(EAN13), JAN8(EAN8), CODE39, Code 2 of 5 Interleaved, CODABAR, CODE93, CODE128, Code 2 of 5 Matrix, Code 2 of 5 Industrial, Code 2 of 5 IATA, Code 2 of 5 Datalogic, CODE11, CODE39 Extended, GS1 DataBar, GS1 DataBar Expanded, MSI Plessey  
2D: PDF417, QR code

### Normal Version

### Scanner Version

### Wi-Fi Version

### Linerless Version

#### Wi-Fi

/

/

Wi-Fi6  
5GHz/2.4GHz  
IEEE 802.11 a/b/g/n/ac/ax

Wi-Fi6  
5GHz/2.4GHz  
IEEE 802.11 a/b/g/n/ac/ax

#### Bluetooth

/

/

Bluetooth 5.4, Support BLE

Bluetooth 5.4, Support BLE

#### Paper Type

Receipt , Label

Receipt , Label

Receipt , Label

Receipt , Label , Linerless

#### Life

Print Life: 150km (Receipt) , 50km (Label)  
Cutter Life: 1000000 (Receipt) , 500000 (Label)

Print Life: 150km (Receipt) , 50km (Label)  
Cutter Life: 1000000 (Receipt) , 500000 (Label)

Print Life: 150km (Receipt) , 50km (Label)  
Cutter Life: 1000000 (Receipt) , 500000 (Label)

Print Life: 150km (Receipt) , 50km (Label, Linerless)  
Cutter Life: 1000000 (Receipt) , 500000 (Label, Linerless)

#### Scanner

/

Reading Precision: 1D: ≥4mil (code128)  
2D: ≥7.5mil (QR Code)  
Symbolologies: 1D: UPC/EAN, Code128, Code39, Code93, Code11, Interleaved 2 of 5, Industrial 2 of 5, Codabar, MSI, Matrix 2 of 5, GS1 DataBar  
2D: QR Code, Data Matrix, PDF417, Aztec

/

/